

Orona 3G

X-37C

Goods Lift

Hydraulic drive solution for heavy loads

Hydraulic drive solution for heavy and/or delicate loads.

General specifications

Load / Capacity	2,550 to 5,000 kg
Speed	0.2 - 0.5 m/s
Maximum travel	21 m
Maximum floors served	7 floors
Entrances	1 front / 2 open through
Drive system	Hydraulic
Controller	ARCA III controller, low energy consumption multiprocessor
Door types	Automatic side-opening / Automatic central-opening
Clear door opening	From 900 to 2,900 mm (in increments of 100 mm)
Door height	2,000 / 2,100 / 2,200 / 2,300
Car dimensions	Parametric car dimensions
Internal car height	2,200 / 2,300 / 2,400 / 2,500
Aesthetic solutions	Heavy loads Aesthetics

Standard Optional

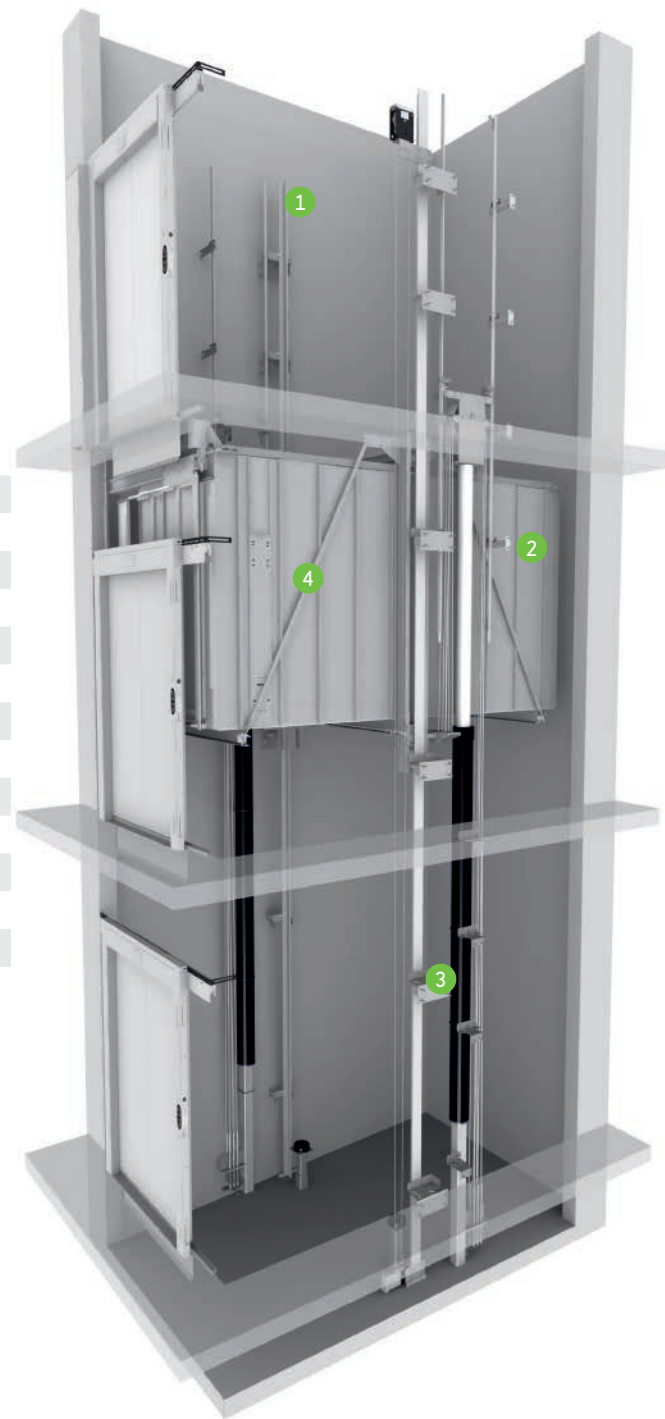

1 HYDRAULIC LIFTS

The hydraulic systems, renowned for their long life cycle, are very versatile and offer convenient solutions to heavy load requirements or reduced shaft spaces.



2 PARAMETRIC/FLEXIBLE

Flexible car and door configurations ensure available shaft dimensions can be optimised.



3 ROBUST LIFT CAR

Provides greater comfort during lift travel, with reduced vibration and noise.



4 CARS

Special car dimensions, with extra depth and wider doors. Designed with reinforced panels and floors for multiple and intensive uses.



ECO-EFFICIENCY



ADAPTABILITY



DESIGN AND ACCESSIBILITY



CONTROL AND SAFETY

Customised solution, examples of dimensions*

Load / Capacity		Car				Lift shaft ⁰					
Speed	Q Load	AC Width	FC Depth	PL Clear opening	Doors Type ²	Entrances	AH ⁴ Min. width	FH ³ Min. depth	HF Min. pit	HUP ⁵ Headroom	
0.2-0.5 m/s	2,550 kg	2,300	1,900	900 - 2,900	PL < 2,100 HH	1	3,100	2,170	1,100	3,550	
		1,900	2,500			2x180 ⁰		2,290			
	3,000 kg	2,300	2,200			PL > 2,200 MM	1	2,700			2,770
							2x180 ⁰				2,890
	3,500 kg	2,500	2,500			1	4,100	2,470			
		2,100	3,000			2x180 ⁰		2,590			
	4,000 kg	2,500	2,800		1	3,300	2,770				
					2x180 ⁰		2,890				
	4,500 kg	2,700	2,800		1	2,900	3,270				
					2x180 ⁰		3,390				
	5,000 kg	3,000	2,800		1	3,300	3,070				
					2x180 ⁰		3,190				
					1	3,500	3,070				
					2x180 ⁰		3,190				
			1	3,800	3,070						
			2x180 ⁰		3,190						

0 Minimum plumb measurements

- 1 The possible car dimensions vary by 50 mm increments only
- 2 Two and three panel telescopic door also possible
- 3 Shaft depth with door tracks projecting 40 mm on the landing and 90 mm sils
- 4 Minimum shaft width for central doors. May vary according to the clear opening and type of doors

5 HUP for interior car height (HC) of 2,200 mm
HUP will be reduced by 70 mm for LED lighting

HH - Four panel central door

MM - Six panel central door

* The information is not contractually binding and is subject to the conditions of the shaft

Layout*

1 ENTRANCE

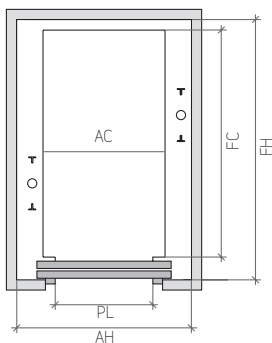

2 ENTRANCES (OPEN THROUGH)

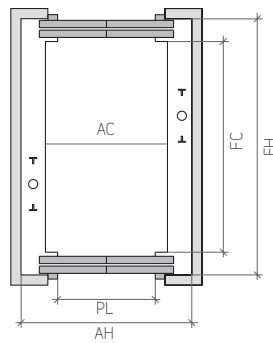

VERTICAL SECTION

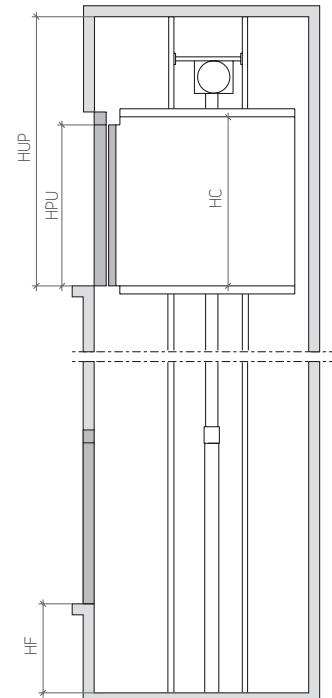

* Note: The diagrams are for guidance only.

Customised car dimensions

Car width										Clear door opening																												
4,500	4,300	4,000	3,800	3,500	3,300	3,000	2,800	2,500	2,200	1,900	900	1,000	1,100	1,200	1,300	1,400	1,500	1,600	1,700	1,800	1,900	2,000	2,100	2,200	2,300	2,400	2,500	2,600	2,700	2,800	2,900							

X = 2,500 - 2,950 kg / O = 3,000 - 3,450 kg / - = 3,500 - 3,950 kg

+ = 4,000 - 4,450 kg / # = 4,500 - 4,950 kg / □ = 5,000 kg

Note: Dimensions considering 1 entrance.

Car width and depth variable, in increments of 50 mm.

For simplification, table samples show increments of 100 mm.